

9xxnm CW 25W Fiber Coupled Diode Laser

P/N: STHL-9xx-25-50

Features:

- High power 25W
- Long lifetime
- Small fiber core diameter 50um

Applications:

- DSSL Pumping
- Scientific research

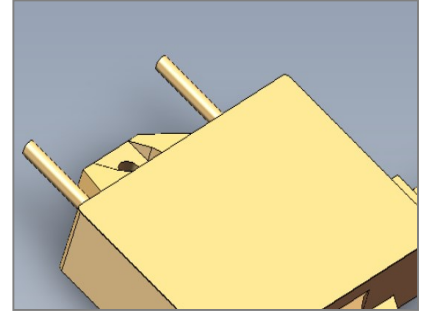

		Unit	Min	Typ.	Max
Optical	Output power	W		25	
	Central wavelength	nm		9xx	
	Wavelength deviation	nm		±5	
	Spectral width FWHM	nm		3	4
	Wavelength shift	nm/°C		0.32	
Fiber	Numerical aperture	NA		0.22	
	Fiber core/cladding	um		50/125	
	Connector			SMA905	
	Fiber length	m	1.4	1.5	1.6
Electrical	Operation current	A		10.5	11
	Threshold current	A		0.7	
	Operation voltage	V		6	
	Slope efficiency	W/A		2.5	
	Electro-optic Conversion eff	%		45	
Thermal	Operation temp.	°C	20		30
	Operation humidity	%			75
	Storage temp	°C	-20		70
	Storage humidity	%	5		85
	Recommended thermal dissipation capacity	W			>40

All the parameters were tested in 25 °C temperature, unless otherwise stated.

